

**7** Score around the edge of the plate with a craft knife. Do use a knife for this - it is very easy to accidentally split the wood with a chisel.



**8** Remove the latch and cut out a slight recess for the rectangular latch plate, using a chisel and mallet.



**9** Refit the latch. Fit the handle spindle and make sure that it will turn freely. Adjust the hole, if necessary. Screw the latch plate in position. Sand off the pencil marks.



**10** To fix the handle plates to each side of the door, start the screw holes with a bradawl, then screw in the screws. If the spindle is too long for the thickness of the door, secure it in a vice and saw to the correct length with a hacksaw.



**11** Close the door so that the latch is touching the frame and mark its position on the frame with a pencil.



**12** Hold the striker plate in position and mark the shape on the frame, including the central cut-out area. Use a narrow chisel to cut a recess for the latch and a wider one to cut around the outer shape and pare away the wood to the depth of the striker plate. Screw the striker plate into position.



## Project essentials:

### Tools ✓

pencil	<input type="checkbox"/>	power drill with wood bits	<input type="checkbox"/>
tape measure	<input type="checkbox"/>	door/board lifter	<input type="checkbox"/>
wood chisels - wide and narrow blades	<input type="checkbox"/>	try square	<input type="checkbox"/>
mallet	<input type="checkbox"/>	craft knife	<input type="checkbox"/>
marking gauge (optional)	<input type="checkbox"/>	bradawl	<input type="checkbox"/>
screwdriver	<input type="checkbox"/>	hacksaw	<input type="checkbox"/>
wooden wedges (optional)	<input type="checkbox"/>		

### Materials ✓

2 or 3 100mm butt hinges and screws	<input type="checkbox"/>	masking tape	<input type="checkbox"/>
door latch and handles	<input type="checkbox"/>	nails (optional)	<input type="checkbox"/>
sandpaper	<input type="checkbox"/>		



### B&Q You can do it book

The complete B&Q step-by-step book of home improvement

A step-by-step guide to fitting a door in its frame can be found in the B&Q You can do it book, available to buy in store now.

Printed on 9lives Offset 100% recycled paper



When you have finished with this leaflet, please recycle it!

A summary of this leaflet can be made available in Braille, large print and audio cassette. Please ask for details or email us at [diversity@b-and-q.co.uk](mailto:diversity@b-and-q.co.uk)

All information correct at time of going to press  
©2011 B&Q Plc. Hampshire, SO53 3LE  
HOWT0198



diy.com

**B&Q** how to...

# fit door furniture



project essentials on the back

Making it easier

Making it easier

Making it easier

**Whether you are hanging a new door in a new frame or a new door in an existing frame, you must make sure that the door fits into it before fitting the hinges. Allow a clearance gap of about 2mm at the top and sides, and 6mm-12mm at the bottom, depending on the thickness of the flooring.**

## Simply follow these steps to fit your door hinges...

**Two hinges are generally enough to support a standard internal door, though in the humid environment of a bathroom or kitchen fit three to help prevent bowing.**

Hinges fit into recesses of an equal depth in the door frame and the stile. You need a very sharp wood chisel with a wide blade for making them.

**1** Mark the position of the upper hinge on the stile, 175mm from the top edge of the door. The lower hinge should be 250mm from the bottom edge of the door. Stand the door on its side edge with the hinge edge uppermost. Hold each hinge on its marked position with the knuckle protruding from the door. Draw round the hinge flap with a sharp pencil.



**2** To mark the depth for the hinge recess, use a marking gauge or hold a hinge flap level with the edge of the door and mark the depth with a pencil.

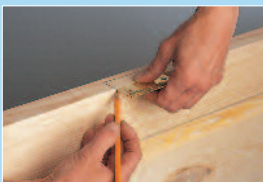

**3** Cut out the hinge recess using a sharp wide-bladed wood chisel and a wooden mallet. First cut the ends and then make a series of cuts along the length of the hinge to approximately the correct depth.



**4** Use the chisel to pare away the surplus wood and trim the recess until it is level.



**5** Test-fit the hinge in the recess and trim it again as necessary. Repeat the process for the other hinge. Position each hinge flap in its recess and drill pilot holes in the screw positions. Screw in the screws with a screwdriver to secure the hinges to the door.



**6** Get a helper to hold the door in the open position in the frame with the hinge flaps against the frame. Tap two screwdrivers or wooden wedges under the door to raise it to the required height to clear the flooring. Make sure the hinge knuckles are parallel with the frame, then mark the frame with a pencil. Remove the door. Chisel out the hinge recesses in the door frame in the same way as those in the door.



**7** Wedge the door in the open position and check that the hinges fit into the recesses. Adjust them, if necessary. Drill pilot holes and screw the hinges to the frame using just one screw per hinge, then check to make sure the door closes smoothly. If it is straining against the hinges (hingebound), undo the screws and pack out the flaps with cardboard. If it rubs on the latch side of the frame, make the hinge recesses slightly deeper. Screw in the remaining hinge screws.



## Ideal for the job

**Door/board lifter** - use this specially designed tool to lever the door into position with your foot, leaving your hands free to mark the hinge positions.



## our top tips

- **Before test-fitting the door, partially hammer four nails into the frame at the depth of the door to prevent it from falling through.**
- **Door furniture isn't just about function - latches, locks, knobs and handles are available in a vast range of shapes and sizes, including reproductions of many traditional styles and designs.**

**you can do it...**



## Simply follow these steps to fit the latch...

**1** Measure and mark the middle point of the centre rail on the side of the door, using a pencil and a try square.



**2** Centre the latch on this line. Holding it in place, draw round the latch. Use the try square to transfer the dimensions to the edge of the door.



**3** Measure the depth of the latch then mark this measurement with a piece of tape on a wood cutting bit the same diameter as the latch. Drill a hole to the correct depth (as far as the tape) in the edge of the door, keeping the drill horizontal and in line with the door. Prise out the debris with a narrow chisel or suck it out with the nozzle of a vacuum cleaner.

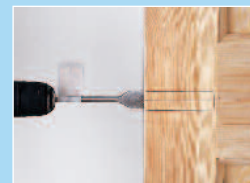

**4** Hold the latch in the correct position on the side of the door and, using a bradawl, mark the position of the handle spindle. Do the same on the other side of the door.



**5** Using a drill with a wood bit, drill a hole at the marked position large enough to give the handle spindle plenty of clearance. Drill from both sides into the latch hole already drilled.



**6** Slide the latch into the hole on the edge of the door and mark the position of the rectangular edge plate with a pencil.

