

There is no need to be put off from buying the ready made curtains you want, simply because they are not the right length for your windows. With DIY iron-on hem you don't need a sewing machine. It's quick, easy and anyone can do it!

tools

- iron
- pencil or chalk
- tape measure
- scissors
- ruler

materials

- DIY iron-on hem
- curtains
- tailors pins

Measure the drop

Decide how long you want your curtains then measure the drop from the curtain pole or track. Remember to take into account the type of fitting and style of curtain you have, as this will effect the eventual length.

- 1 Make sure you have a clear, clean working space. Lay the first curtain flat and face down so you are looking at the reverse side. Measure from the curtain tape the length of the drop plus 100mm, this is to allow for the hem. Mark with chalk or pencil onto the fabric. Take several measurements and use a long ruler to get a straight cutting line. Repeat with the other curtain.

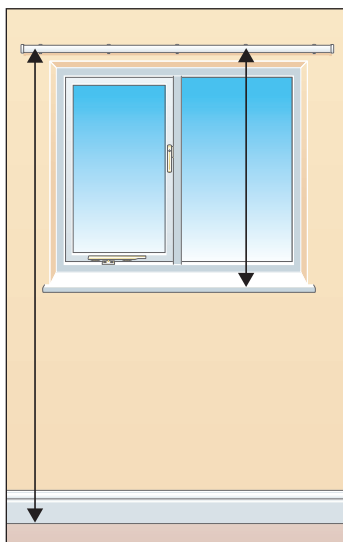

- 2 Cut off the excess fabric using sharp scissors.

Making the hem

- 3 Set the iron temperature to wool/polyester. With the curtain face down measure 50mm from the bottom and fold the fabric; fold it again another 50mm, use pins to hold the hem in place. Iron along the folds so that you have a crisp crease.

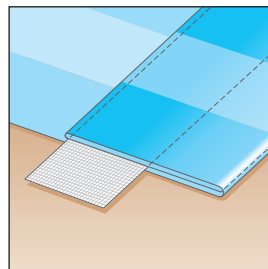
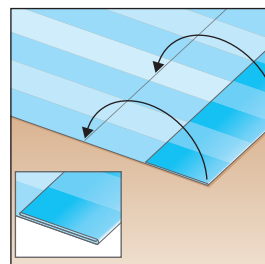

- 4 Remove the pins and lift the fabric up along the crease. Lay the iron-on hem adhesive strip inside the fold and adjacent to the crease. Do this along the full width of the curtain and cut the strip off at the end. Make sure it reaches right to the edge.

- 5 Check that you have the adhesive strip lying flat and sandwiched neatly between the fabric. Run the hot iron over each section of the hem holding and pressing for 6 – 10 seconds. Work your way across the width of the curtain being careful you don't stretch the fabric. Allow 2 minutes for the adhesive to set before you move the fabric. Now do the same on the other curtain.

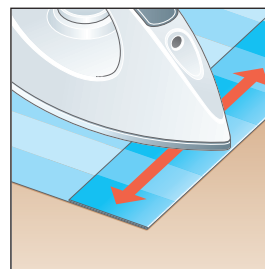

how to... fit a roller blind and hem curtains

tools

- tape measure
- pencil
- large scissors
- long ruler
- spirit level
- step ladder
- junior hacksaw
- screwdriver
- bradawl (fixing to wood)
- power drill (fixing to wall)
- masonry bit (fixing to wall)

materials

- roller blind kit
- wall plugs (fixing to wall)
- hollow-wall fixings (fixing to plasterboard)



Please remember to recycle this leaflet when you have finished, you could even compost it as the leaflet has been printed using vegetable-based inks.

A summary of this leaflet can be made available in Braille, large print and audio cassette. Please ask for details or email us at diversity@b-and-q.co.uk

Every effort has been made to ensure that the instructions given in this leaflet are accurate and will enable you to do the job safely and successfully. Please follow instructions carefully and seek expert advice in the event of difficulty.

©2008 B&Q plc. Hampshire, SO53 3YX

All information correct at time of going to print.

HOWT0102

Roller blinds are inexpensive to buy and easy to install. They come in a wide range of exciting colours and fabrics which means you can quickly create the look you want. Don't worry if there is not one to fit your window as most can be cut to size.

Where to fit the blind

You can either fit the roller blind inside a window recess or outside so that it lies flush with the wall. Whichever method you choose make sure there is a little clearance at both ends to aid smooth operation of the mechanism.

Which size?

If you are fitting the blind into a window recess, measure the full width of the recess and buy a blind slightly smaller than this measurement, however for fitting outside a recess add 100mm. If the roller blind you wish to buy is not produced in the correct width, check that it can be re-sized and buy the next size up.

Fitting inside a window recess

Decide on the best position for the brackets which hold up the roller. They can either be fitted in each corner of a wooden frame, the top or sides of the recess. The type of window you have may dictate where the fixings must go, but if not you should choose whichever will look best. You may need to reduce the size of the blind; but first fix the brackets in place, then you can measure the distance between them and cut the blind to fit.



Check the manufacturers instructions for the correct measurements and hold up each bracket, either against the wooden frame, the top or sides of the recess. Mark the position with a pencil. If the blind is the right size straight from the pack, then the distance between the brackets should be the width of the blind.

Fitting outside a window recess

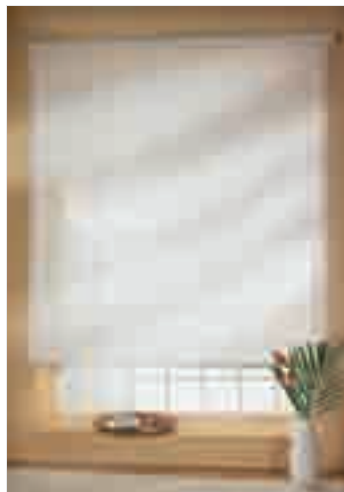

Measure 50mm above the top of the recess and mark with a pencil. This is the height above the recess where you will fit the blind. Find the centre point of the recess and mark lightly. Find the centre of the blind and mark lightly. Ask a helper to hold the blind in place matching both of these centre points. Use a spirit level and mark the position of the brackets. If there is not enough clearance above the window frame then you can fix to the ceiling instead.

Fitting the brackets

1 Mark with a pencil through the holes in each bracket. Fix the first bracket using the screws provided in the pack. Hold the second bracket in place and double check they are level using a spirit level, then fix the second one in place.

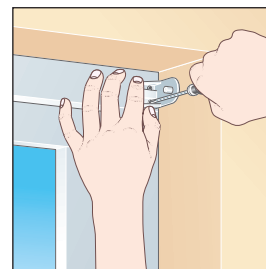

Fixing to a wall

Use a power drill with a suitable masonry bit to drill holes in the positions you have marked, then insert wall plugs.

Fixing to wood

If you are fixing to soft wood use a bradawl to make starting holes in the positions you have marked, then use a screwdriver or power driver to insert the screws. If the wood is hard, use a power drill fitted with a suitable wood bit.

Fixing to a ceiling or plasterboard wall

Use a power drill with a suitable bit to drill the holes and then insert hollow-wall fixings. If in doubt seek professional advice.

2 Decide from which side of the window you wish to operate the blind and fit the sidewinder mechanism to this end of the tube. Check the pack instructions and correctly position the cord or bead pull. Fit the end plug into the other end of the tube.

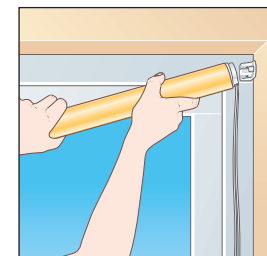
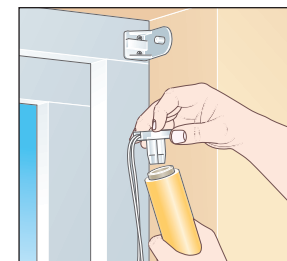

3 Decide from which side of the window you wish to operate the blind and fit the sidewinder mechanism to this end of the tube. Check the pack instructions and correctly position the cord or bead pull. Fit the end plug into the other end of the tube.

B&Q you can do it

Learn more about fixing to wood and walls with the bestselling **you can do it – the complete B&Q step-by-step book of home improvement. Only £16.98**



Cutting to size

To calculate where to cut the blind, measure the distance between the brackets in the window recess and then deduct the width of the sidewinder and end plug. The manufacturers' instructions should give you the measurement to deduct. Unroll the blind fully and mark where you need to cut on both the top roller tube and bottom bar. Cut through using a junior hacksaw. With a long ruler lightly mark with a pencil where you need to cut the fabric and then carefully cut off the excess using sharp scissors. If the blind has a centrally placed pattern, then you will have to cut an equal amount from both sides so that the design remains in the middle.

How to cut the tube

To get a neat, straight edge when you cut the roller tube; wrap a piece of tape around the tube on the inside of your pencil mark, now you can cut using the tape as a guide.

